

2022

Flange Dimensions and Weight Chart

Website: <https://www.schulzmann.com>

Email: info@schulzmann.com



**PIPE
Flange
FOR SALE**

ADVANTAGES

- Provide Better Flexibility
- They Fit Well In Tight Spaces
- Flanges Provide Easy Maintenance
- Flange Connections And Fittings Aren't Likely To Loosen

VISIT NOW

WWW.SCHULZMANN.COM

- Dimensions
- Weight
- Thickness
- Size Chart
- Bolts Chart





What Is Wall Thickness Is A Flange?

Choosing the appropriate flange for the purpose is essential. The flange should fit precisely into the pipe joints for it to work. A slight miscalculation in flange selection could significantly impact the operation and cost you money. You can address the factors influencing selecting the proper flange compatible with the applications for maximum usage.

Several different factors affect flange size. The appropriate pressure class, norms, and flange measurement are a few examples. Influences include the inner and outer diameters, the number and size of the fastener holes, and the bolt radius. Flanges come in various Flange Dimensions, from 48" (1200NB) through 1/2". (15NB).

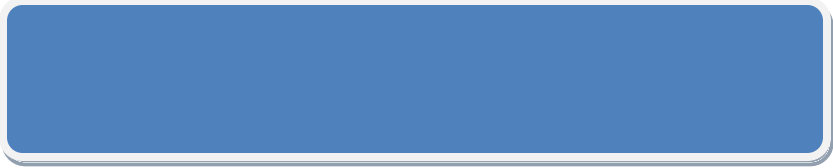

Check the thickness and Size Chart of Pipe Flanges

How Can You Evaluate The Size Of A Flange?

It's crucial to choose the right Flange Thickness. For a precise match, test your flange according to the instructions below and compare the results to the dimensions. The PCD, which can indicate whether the flange bolt holes will line up, is one of the most crucial metrics.

From one end of the inner hole to the other side of the hole, calculate across the center. Check across the center from one external border of the material to the other.



How Do You Calculate Flange Weight?

Pipe Flanges Mass Table to ASME B 16.5 Weight is in Kilograms. The mass of the flange's tail end with a wide surface. $W = (A1^2 - D1^2 * C1) * C * 6.228 / 1000000$ (Kg)

The most famous pipe flange facing with an elevated face is an example. There are two portions to the weight of the high flange. One component can be considered a short piece of pipe, and the other as a cone that a cylinder has reduced. A weld neck flange weighs the same as the sum of the individual weights.

Formula 1: $W = [(A1^2 - B1^2 - D1^2 * C1) * C + (X^2 - A^2) * H] * 6.228 / 1000000$

Formula 2: $W = [(A1^2 - B1^2 - D1^2 * C1) * C - (A1^2 - X^2 - D1^2 * C1) * H] * 6.228 / 1000000$

Depending on the flange's physical or mathematical modeling, pipe flange weight calculations are made. Theoretical weight can be computed directly using the Flange Weight Chart



A complete guide of Industrial Steel flange, view specification and pressure rating

MANUFACTURING FACILITIES :

1. *Heating : Annealing Solution*
2. *Drilling : VMC, radial drill/ column drill machines*
3. *Band Saw Machines to cut raw material from 20 mm to 1050 mm*
4. *Machinable Flanges: blind lens rings, raised face, ring groove, full face, flange plus connections.*
5. *Forge: open die forging, seamless rolled ring forging, cold forging, impression die forging.*

FLANGE-FACING TYPES :

- Flat-face (FF)
- Raised face
- Large Raised face
- Ring Type Joint (RTJ)
- Tongue & Groove face (T&G)
- Male-Female face

FLANGE FACE FINISH :

- Stock Finish (Serration),
- Smooth Finish
- Concentric Serrated
- Phonographic Serrated
- Spiral Serrated
- Continuous Serrated

IMPORTANT TYPES :

[Slip On Flange](#)

[Weld Neck Flange](#)

[Blind Flange](#)

[Socket Weld Flange](#)

[Lap Joint Flanges](#)

[Threaded Flange](#)

[Orifice Flange](#)

FLANGES STANDARDS :

[DIN 2633 Flange](#)

[DIN 2527 Flange](#)

[DIN 2501 Flange](#)

[JIS 16K Flange](#)

[BS 10 Table D Flange](#)

[API Flange](#)

[EN 1092-1 Flange](#)

The flange weight depends upon the material, check flange faces and pressure class

Page (4)

TESTING FACILITIES :

- *Dye penetrate test of Flanges*
- *Spectra Analyser (PMI test)*
- *Radiation servo meter*
- *Gamma ray spectroscopy*
- *Tensile Test computerized*
- *Roughness Testing on Surface*
- *Impact Test*
- *Hardness Test*

FLANGE TYPE CODES :

- 101 – Plate flange for welding*
- 104 – Loose plate flange with weld-nut collar*
- 105 – Blank flange*
- 111 – Weld neck flange*
- 112 – Hubbed slip-on flange for welding*
- 113 – Hubbed threaded flange*
- 121 – Integral flange*



Dimensions

Refer 150 LB Weld Neck/ Blind/ Slip On Flange dimensions, thickness, size and weight chart

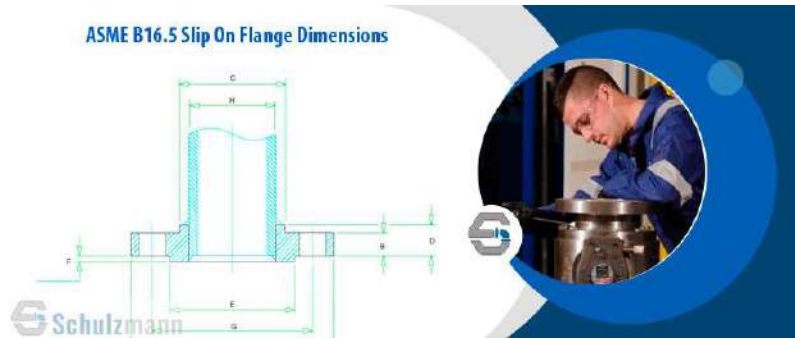

Size in (MM)	OD	Flange Thick.	O.D. Of Hub	Length Of Flanges	Diameter Of R/F	Height Of R/F	PCD	Bore Of Socket	Number of Bolts
	(A)	(B)	(C)	(D)	(E)	(F)	(G)	(H)	
15	90	9.6	30	14	34.9	2	60.3	22.2	4
20	100	11.2	38	14	42.9	2	69.9	27.7	4
25	110	12.7	49	16	50.8	2	79.4	34.5	4
32	115	14.3	59	19	63.5	2	88.9	43.2	4



40	125	15.9	65	21	73	2	98.4	49.5	4
50	150	17.5	78	24	92.1	2	120.7	61.9	4
65	180	20.7	90	27	104.8	2	139.7	74.6	4
80	190	22.3	108	29	127	2	152.4	90.7	4
90	215	22.3	122	30	139.7	2	177.8	103.4	8
100	230	22.3	135	32	157.2	2	190.5	116.1	8
125	255	22.3	164	35	185.7	2	215.9	143.8	8
150	280	23.9	192	38	215.9	2	241.3	170.7	8
200	345	27	246	43	269.9	2	298.5	221.5	8
250	405	28.6	305	48	323.8	2	362	276.2	12
300	485	30.2	365	54	381	2	431.8	327	12
350	535	33.4	400	56	412.8	2	476.3	359.2	12
400	595	35	457	62	469.9	2	539.8	410.5	16
450	635	38.1	505	67	533.4	2	577.9	461.8	16
500	700	41.3	559	71	584.2	2	635	513.1	20

Flanges supply with Final visual inspection, 100% radiographed

ASME B16.5 WELD NECK FLANGE DIMENSIONS IN MM

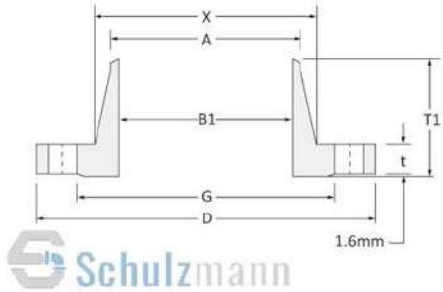

Size In Inch	D In (MM)	X In (MM)	G In (MM)	t In (MM)	B1 In (millimeter)	T1 In (millimeter)
1/2	89	30.2	35.1	11.2	15.7	47.8
3/4	99	38.1	42.9	12.7	20.8	52.3
1	108	49.3	50.8	14.2	26.7	55.6
1¼	117	58.7	63.5	15.7	35.1	57.2
1½	127	65.0	73.2	17.5	40.9	62.0
2	152	77.7	91.9	19.1	52.6	63.5
2½	178	90.4	104.6	22.4	62.7	69.9
3	191	108.0	127.0	23.9	78.0	69.9
3½	216	122.2	139.7	23.9	90.2	71.4
4	229	134.9	157.2	23.9	102.4	76.2
5	254	163.6	185.7	23.9	128.3	88.9
6	279	192.0	215.9	25.4	154.2	88.9



8	343	246.1	269.7	28.4	202.7	101.6
10	406	304.8	323.9	30.2	254.5	101.6
12	483	365.3	381.0	31.8	304.8	114.3
14	533	400.1	412.8	35.1	336.6	127.0
16	597	457.2	469.9	36.6	387.4	127.0
18	635	505.0	533.4	39.6	438.2	139.7
20	699	558.8	584.2	42.9	489.0	144.5
24	813	663.4	692.2	47.8	590.6	152.4

ASME B16.5 BLIND FLANGE

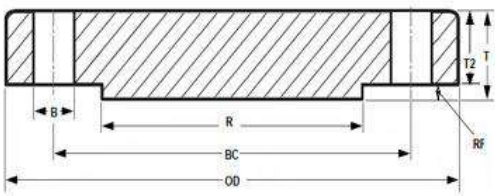

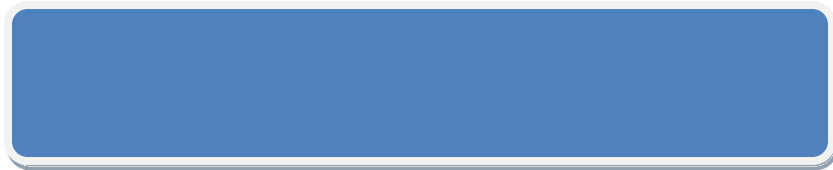

Size in (Inch)	Size (mm)	OD	Thick.	Dia Of R/F	H Of R/F	PCD	No of Bolts	Size Of UNC Bolts	Length Of Machine Bolt
		A	B	C	D	E			
1/2	15	90	9.6	34.9	2	60.3	4	1/2	50
3/4	20	100	11.2	42.9	2	69.9	4	1/2	50
1	25	110	12.7	50.8	2	79.4	4	1/2	55
1 1/4	32	115	14.3	63.5	2	88.9	4	1/2	55
1 1/2	40	125	15.9	73	2	98.4	4	1/2	65
2	50	150	17.5	92.1	2	120.7	4	5/8	70
2 1/2	65	180	20.7	104.8	2	139.7	4	5/8	75
3	80	190	22.3	127	2	152.4	4	5/8	75
3 1/2	90	215	22.3	139.7	2	177.8	8	5/8	75
4	100	230	22.3	157.2	2	190.5	8	5/8	75
5	125	255	22.3	185.7	2	215.9	8	3/4	85
6	150	280	23.9	215.9	2	241.3	8	3/4	85
8	200	345	27	269.9	2	298.5	8	3/4	90
10	250	405	28.6	323.8	2	362	12	7/8	100
12	300	485	30.2	381	2	431.8	12	7/8	100



14	350	535	33.4	412.8	2	476.3	12	1	115
16	400	595	35	469.9	2	539.8	16	1	115
18	450	635	38.1	533.4	2	577.9	16	1 1/8	125
20	500	700	41.3	584.2	2	635	20	1 1/8	140
24	600	815	46.1	692.2	2	749.3	20	1 1/4	150

Industrial flange dimensions as per ANSI B16.5, check 150 to class 2500 flange dimensions in mm

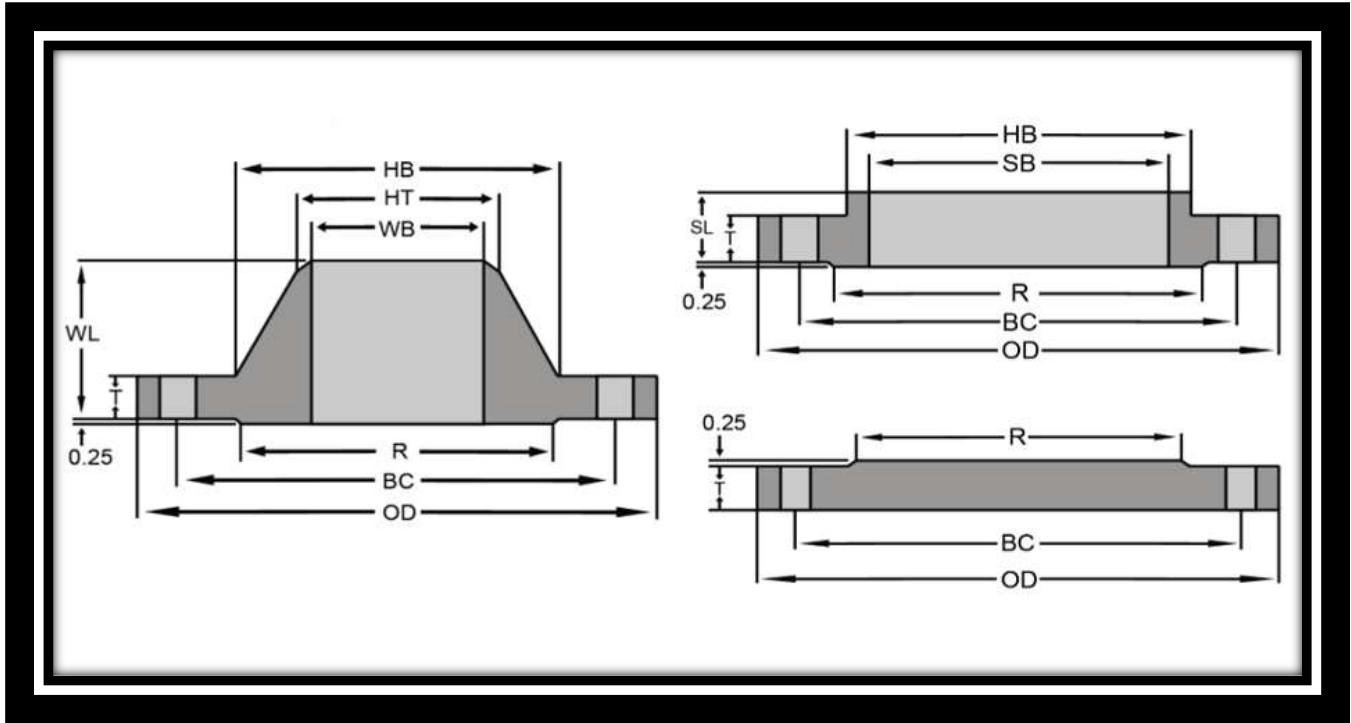

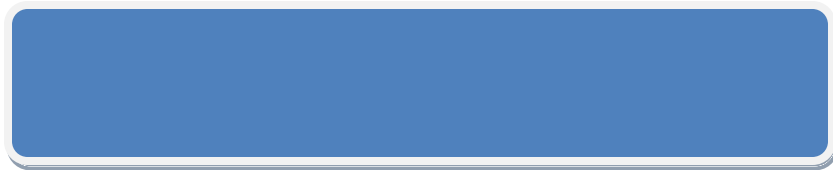

NPS	(OD)	Min. Thick (T)	RF Diameter (R)	Number of Bolt Holes	Holes Diameter	Bolt Circle	SO Bore ID (SB)	WN Bore ID (WB)
1/2	3.50	0.38	1.38	4	0.62	2.38	0.88	0.62
3/4	3.88	0.44	1.69	4	0.62	2.75	1.09	0.82
1	4.25	0.50	2.00	4	0.62	3.12	1.36	1.05
1 1/4	4.62	0.56	2.50	4	0.62	3.50	1.70	1.38
1 1/2	5.00	0.62	2.88	4	0.62	3.88	1.95	1.61
2	6.00	0.69	3.62	4	0.75	4.75	2.44	2.07
2 1/2	7.00	0.81	4.12	4	0.75	5.50	2.94	2.47
3	7.50	0.88	5.00	4	0.75	6.00	3.57	3.07
3 1/2	8.50	0.88	5.50	8	0.75	7.00	4.07	3.55
4	9.00	0.88	6.19	8	0.75	7.50	4.57	4.03
5	10.00	0.88	7.31	8	0.88	8.50	5.66	5.05
6	11.00	0.94	8.50	8	0.88	9.50	6.72	6.07
8	13.50	1.06	10.62	8	0.88	11.75	8.72	7.98
10	16.00	1.12	12.75	12	1.00	14.25	10.88	10.02
12	19.00	1.19	15.00	12	1.00	17.00	12.88	12.00
14	21.00	1.31	16.25	12	1.12	18.75	14.14	13.25
16	23.50	1.38	18.50	16	1.12	21.25	16.16	15.25
18	25.00	1.50	21.00	16	1.25	22.75	18.18	17.25
20	27.50	1.62	23.00	20	1.25	25.00	20.20	19.25
22	29.50	1.75	25.25	20	1.38	27.25	22.22	21.25
24	32.00	1.81	27.25	20	1.38	29.50	24.25	23.25

Steel Forged Flange with Mill test reports in UAE

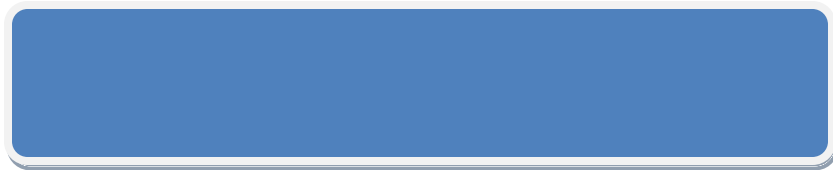

Weight Chart

NOMINAL SIZE		DIMENSIONS		WEIGHT (KG)		
NPS (Inches)	DN (mm)	FLANGE MM	FLANGE THICKNESS	SOW SW	WN	BLIND
1/2	15	88.9	11.2	0.4	0.5	0.4
3/4	20	98.6	12.7	0.6	0.7	0.6
1	25	108	14.2	0.8	1	0.9
1 1/4	32	117.3	15.7	1	1.3	1.2
1 1/2	40	127	17.5	1.3	1.7	1.5
2	50	152.4	19.1	2.1	2.6	2.4
2 1/2	65	177.8	22.4	3.3	4.1	3.9
3	80	190.5	23.9	3.9	4.9	4.9
3 1/2	90	215.9	23.9	4.8	6.1	6.2
4	100	228.6	23.9	5.3	6.8	7.0
5	125	254	23.9	6.1	8.6	8.6
6	150	279.4	25.4	7.5	10.6	11.3
8	200	342.9	28.4	12.1	17.6	19.6
10	250	406.4	30.2	16.5	24	28.6
12	300	482.6	31.8	26.2	36.5	43.2
14	350	533.4	35.1	34.6	48.4	58.1
16	400	596.9	36.6	44.8	60.6	76.1
18	450	635	39.6	48.9	68.3	93.7
20	500	698.5	42.9	61.9	84.5	122.0
24	600	812.8	47.8	86.9	115	185.0



WELD NECK



SLIP-ON



SOCKET WELD



LAP JOINT



THREADED



BLIND



Thickness

NPS	OD	10 (SCH)	20 (SCH)	30 (SCH)	STD Wall	40 (SCH)	140 (SCH)	160 (SCH)
1/2	0.84	0.083	0.109	0.109	...	0.188
3/4	1.05	0.083	0.113	0.113	...	0.219
1	1.315	0.109	0.133	0.133	...	0.25
1 1/4	1.66	0.109	0.14	0.14	...	0.25
1 1/2	1.9	0.109	0.145	0.145	...	0.281
2	2.375	0.109	0.154	0.154	...	0.344
2 1/2	2.875	0.12	0.203	0.203	...	0.375
3	3.5	0.12	-	-	0.216	0.216	-	0.438
3 1/2	4	0.12	-	-	0.226	0.226	-	-
4	4.5	0.12	-	-	0.237	0.237	-	0.531
5	5.563	0.134	-	-	0.258	0.258	-	0.625
6	6.625	0.134	-	-	0.28	0.28	-	0.719
8	8.625	0.148	0.25	0.277	0.322	0.322	0.812	0.906
10	10.75	0.165	0.25	0.307	0.365	0.365	1	1.125
12	12.75	0.18	0.25	0.33	0.375	0.406	1.125	1.312
14	14	0.25	0.312	0.375	0.375	0.438	1.25	1.406
16	16	0.25	0.312	0.375	0.375	0.5	1.438	1.594
18	18	0.25	0.312	0.438	0.375	0.562	1.562	1.781
20	20	0.25	0.375	0.5	0.375	0.594	1.75	1.969
22	22	0.25	-	-	0.375	-	-	-
24	24	0.25	0.375	0.562	0.375	0.688	2.062	2.344
26	26	-	-	-	0.375	-	-	-

Industrial Pipe Flange at Lowest Price for Piping industry and Petrochemical Plants

Size Chart

Nominal Pipe Size NPS (inches)	Class 150				
	Diameter of Flange (inches)	No. of Bolts	Diameter of Bolts (inches)	Diameter of Bolt Holes (inches)	Bolt Circle (inches)
1/4	3-3/8	4	1/2	0.62	2-1/4
1/2	3-1/2	4	1/2	0.62	2-3/8
3/4	3-7/8	4	1/2	0.62	2-3/4
1	4-1/4	4	1/2	0.62	3-1/8
1-1/4	4-5/8	4	1/2	0.62	3-1/2
1-1/2	5	4	1/2	0.62	3-7/8
2	6	4	5/8	0.75	4-3/4
2-1/2	7	4	5/8	0.75	5-1/2
3	7-1/2	4	5/8	0.75	6
3-1/2	8-1/2	8	5/8	0.75	7
4	9	8	5/8	0.75	7-1/2
5	10	8	3/4	0.88	8-1/2
6	11	8	3/4	0.88	9-1/2
8	13-1/2	8	3/4	0.88	11-3/4
10	16	12	7/8	1	14-1/4
12	19	12	7/8	1	17
14	21	12	1	1.12	18-3/4
16	23-1/2	16	1	1.12	21-1/4
18	25	16	1-1/8	1.25	22-3/4
20	27-1/2	20	1-1/8	1.25	25

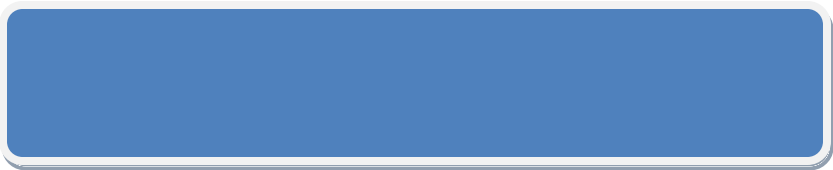

Nominal Pipe Size NPS (inches)	Class 300				
	Diameter of Flange (inches)	No. of Bolts	Diameter of Bolts (inches)	Diameter of Bolt Holes (inches)	Bolt Circle (inches)
1/4	3-3/8	4	1/2	0.62	2-1/4
1/2	3-3/4	4	1/2	0.62	2-5/8
3/4	4-5/8	4	5/8	0.75	3-1/4
1	4-7/8	4	5/8	0.75	3-1/2
1-1/4	5-1/4	4	5/8	0.75	3-7/8
1-1/2	6-1/8	4	3/4	0.88	4-1/2
2	6-1/2	8	5/8	0.75	5
2-1/2	7-1/2	8	3/4	0.88	5-7/8
3	8-1/4	8	3/4	0.88	6-5/8
3-1/2	9	8	3/4	0.88	7-1/4
4	10	8	3/4	0.88	7-7/8
5	11	8	3/4	0.88	9-1/4
6	12-1/2	12	3/4	0.88	10-5/8
8	15	12	7/8	1	13
10	17-1/2	16	1	1.12	15-1/4
12	20-1/2	16	1-1/8	1.25	17-3/4
14	23	20	1-1/8	1.25	20-1/4
16	25-1/2	20	1-1/4	1.38	22-1/2
18	28	24	1-1/4	1.38	24-3/4
20	30-1/2	24	1-1/4	1.38	27
24	36	24	1-1/2	1.62	32



Nominal Pipe Size NPS (inches)	Class 600				
	Diameter of Flange (inches)	No. of Bolts	Diameter of Bolts (inches)	Diameter of Bolt Holes (inches)	Bolt Circle (inches)
1/4	3-3/8	4	1/2	0.62	2-1/4
1/2	3-3/4	4	1/2	0.62	2-5/8
3/4	4-5/8	4	5/8	0.75	3-1/4
1	4-7/8	4	5/8	0.75	3-1/2
1-1/4	5-1/4	4	5/8	0.75	3-7/8
1-1/2	6-1/8	4	3/4	0.88	4-1/2
2	6-1/2	8	5/8	0.75	5
2-1/2	7-1/2	8	3/4	0.88	5-7/8
3	8-1/4	8	3/4	0.88	6-5/8
3-1/2	9	8	7/8	1	7-1/4
4	10-3/4	8	7/8	1	8-1/2
5	13	8	1	1.12	10-1/2
6	14	12	1	1.12	11-1/2
8	16-1/2	12	1-1/8	1.25	13-3/4
10	20	16	1-1/4	1.38	17
12	22	20	1-1/4	1.38	19-1/4
14	23-3/4	20	1-3/8	1.5	20-3/4
16	27	20	1-1/2	1.62	23-3/4
18	29-1/4	20	1-5/8	1.75	25-3/4
20	32	24	1-5/8	1.75	28-1/2
24	37	24	1-7/8	2	33



Nominal Pipe Size NPS (inches)	Class 900				
	Diameter of Flange (inches)	No. of Bolts	Diameter of Bolts (inches)	Diameter of Bolt Holes (inches)	Bolt Circle (inches)
1/2	4-3/4	4	3/4	0.88	3-1/4
3/4	5-1/8	4	3/4	0.88	3-1/2
1	5-7/8	4	7/8	1	4
1-1/4	6-1/4	4	7/8	1	4-3/8
1-1/2	7	4	1	1.12	4-7/8
2	8-1/2	8	7/8	1	6-1/2
2-1/2	9-5/8	8	1	1.12	7-1/2
3	9-1/2	8	7/8	1	7-1/2
4	11-1/2	8	1-1/8	1.25	9-1/4
5	13-3/4	8	1-1/4	1.38	11
6	15	12	1-1/8	1.25	12-1/2
8	18-1/2	12	1-3/8	1.5	15-1/2
10	21-1/2	16	1-3/8	1.5	18-1/2
12	24	20	1-3/8	1.5	21
14	25-1/4	20	1-1/2	1.62	22
16	27-3/4	20	1-5/8	1.75	24-1/2
18	31	20	1-7/8	2	27
20	33-3/4	20	2	2.12	29-1/2
24	41	20	2-1/2	2.62	35-1/2



Nominal Pipe Size NPS (inches)	Class 1500				
	Diameter of Flange (inches)	No. of Bolts	Diameter of Bolts (inches)	Diameter of Bolt Holes (inches)	Bolt Circle (inches)
1/2	4-3/4	4	3/4	0.88	3-1/4
3/4	5-1/8	4	3/4	0.88	3-1/2
1	5-7/8	4	7/8	1	4
1-1/4	6-1/4	4	7/8	1	4-3/8
1-1/2	7	4	1	1.12	4-7/8
2	8-1/2	8	7/8	1	6-1/2
2-1/2	9-5/8	8	1	1.12	7-1/2
3	10-1/2	8	1-1/8	1.25	8
4	12-1/4	8	1-1/4	1.38	9-1/2
5	14-3/4	8	1-1/2	1.62	11-1/2
6	15-1/2	12	1-3/8	1.5	12-1/2
8	19	12	1-5/8	1.75	15-1/2
10	23	12	1-7/8	2	19
12	26-1/2	16	2	2.12	22-1/2
14	29-1/2	16	2-1/4	2.38	25
16	32-1/2	16	2-1/2	2.62	27-3/4
18	36	16	2-3/4	2.88	30-1/2
20	38-3/4	16	3	3.12	32-3/4
24	46	16	3-1/2	3.62	39

Forging Flange all sizes and wall thickness suitable for B31 Piping Systems



Nominal Pipe Size NPS (inches)	Class 2500				
	Diameter of Flange (inches)	No. of Bolts	Diameter of Bolts (inches)	Diameter of Bolt Holes (inches)	Bolt Circle (inches)
1/2	5-1/4	4	3/4	0.88	3-1/2
3/4	5-1/2	4	3/4	0.88	3-3/4
1	6-1/4	4	7/8	1	4-1/4
1-1/4	7-1/4	4	1	1.12	5-1/8
1-1/2	8	4	1-1/8	1.25	5-3/4
2	9-1/4	8	1	1.12	6-3/4
2-1/2	10-1/2	8	1-1/8	1.25	7-3/4
3	12	8	1-1/4	1.38	9
4	14	8	1-1/2	1.62	10-3/4
5	16-1/2	8	1-3/4	1.88	12-3/4
6	19	8	2	2.12	14-1/2
8	21-3/4	12	2	2.12	17-1/4
10	26-1/2	12	2-1/2	2.62	21-1/4
12	30	12	2-3/4	2.88	24-3/8



WELD NECK



SLIP-ON



SOCKET WELD



LAP JOINT



THREADED



BLIND

Bolts Chart

Size in (Inches)	Size in (Millimeter)	Bolts Number	Bolts Size In UNC	Stud Length (RF)	Stud Size In ISO	Machine Bolts Length
1/2	15	4	1/2	55	M14	50
3/4	20	4	1/2	65	M14	50
1	25	4	1/2	65	M14	55
1 1/4	32	4	1/2	70	M14	55
1 1/2	40	4	1/2	70	M14	65
2	50	4	5/8	85	M16	70
2 1/2	65	4	5/8	90	M16	75
3	80	4	5/8	90	M16	75
3 1/2	90	8	5/8	90	M16	75
4	100	8	5/8	90	M16	75
5	125	8	3/4	95	M20	85
6	150	8	3/4	100	M20	85
8	200	8	3/4	110	M20	90
10	250	12	7/8	115	M24	100
12	300	12	7/8	120	M24	100
14	350	12	1	135	M27	115
16	400	16	1	135	M27	115
18	450	16	1 1/8	145	M30	125
20	500	20	1 1/8	160	M30	140
24	600	20	1 1/4	170	M33	150



WELD NECK



SLIP-ON



SOCKET WELD



LAP JOINT



THREADED



BLIND

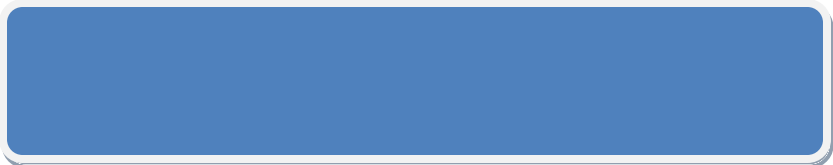

Pressure Rating

Temperature (Degree C)	Class Of Blind Flanges						
	(150#)	(300#)	(400#)	(600#)	(900#)	(1500#)	(2500#)
-29 - 38	19.8	51.7	68.9	103.4	155	259	431
50	19.5	51.7	68.9	103.4	155	259	431
100	17.7	51.5	68.7	103.0	155	258	429
150	15.8	50.2	66.8	100.3	151	251	418
200	13.8	48.6	64.8	97.2	146	243	405
250	12.1	46.3	61.7	92.7	139	232	386
300	10.2	42.9	57.0	85.7	129	214	357
325	9.3	41.4	55.0	82.6	124	207	344
350	8.4	40.0	53.4	80.0	120	200	334
375	7.4	37.8	50.4	75.7	114	189	315
400	6.5	34.7	46.3	69.4	104	174	290
425	5.5	28.8	38.4	57.5	86.3	144	240
450	4.6	23.0	30.7	46.0	69.0	115	192
475	3.7	17.1	22.8	34.2	51.3	85.4	142
500	2.8	11.6	15.4	23.2	34.7	57.9	96.5
538	1.4	5.9	7.9	11.8	17.7	29.5	49.2



Markings



Application :

- ✓ Power Generation
- ✓ Chemical Equipment
- ✓ Gas Processing
- ✓ Pulp and Paper Industry
- ✓ Sea Water Equipment
- ✓ Pharmaceutical Equipment
- ✓ Oil & Gas Industry

Benefits :

- Hard-to-reach areas where you need flexibility*
- Easy assembly*
- Easy Access*
- No welding, painting or blasting*
- Fast fabrication and ease of modification*



WELD NECK



SLIP-ON



SOCKET WELD



LAP JOINT



THREADED



BLIND

SUPPLIER & MANUFACTURER IN UAE



- SIZE : 1/2 TO 48
- CLASS : 150 -2500
- SCH : 10S TO 160S
- STANDARD : ASME B16.5

MORE INFO

WWW.SCHULZMANN.COM

Visit Our Factory :

Jebel Ali Free Zone (North R/A #13, Behind ENOC Fuel Station), Dubai, UAE

Website <https://www.schulzmann.com> **Email ID :** sales@schulzmann.com